



# PALMDALE WATER DISTRICT

2029 East Avenue Q • Palmdale, California 93550 •

Telephone (661) 947-4111

Fax (661) 947-8604

[www.palmdalewater.org](http://www.palmdalewater.org)

## Board of Directors

ROBERT E. ALVARADO  
Division 1

GORDON G. DEXTER  
Division 2

GLORIA DIZMANG  
Division 3

KATHY MAC LAREN  
Division 4

STEVE R. CORDOVA  
Division 5

LAGERLOF, SENECA, GOSNEY & KRUSE LLP  
Attorneys



October 31, 2012

*Agenda for a Meeting  
of the Outreach Committee of the Palmdale Water District  
Committee Members: Gloria Dizmang-Chair, Robert Alvarado  
to be held at the District's office at 2029 East Avenue Q, Palmdale*

*Monday, November 5, 2012*

*3:00 p.m.*

NOTE: To comply with the Americans with Disabilities Act, to participate in any Board meeting please contact Dawn Deans at 661-947-4111 x1003 at least 48 hours prior to a Board meeting to inform us of your needs and to determine if accommodation is feasible.

Agenda item materials, as well as materials related to agenda items submitted after distribution of the agenda packets, are available for public review at the District's office located at 2029 East Avenue Q, Palmdale. Please call Dawn Deans at 661-947-4111 x1003 for public review of materials.

PUBLIC COMMENT GUIDELINES: The prescribed time limit per speaker is three-minutes. Please refrain from public displays or outbursts such as unsolicited applause, comments, or cheering. Any disruptive activities that substantially interfere with the ability of the District to carry out its meeting will not be permitted and offenders will be requested to leave the meeting.

Each item on the agenda shall be deemed to include any appropriate motion, resolution, or ordinance to take action on any item.

- 1) Roll Call.
- 2) Adoption of Agenda.
- 3) Public Comments.
- 4) Action Items: (The public shall have an opportunity to comment on any action item as each item is considered by the Committee prior to action being taken.)
  - 4.1) Consideration and possible action on approval of minutes of meeting held October 8, 2012.

- 4.2) Discussion of next issue of Water News. (Water Conservation Supervisor Roberts)
- 4.3) Discussion of "Before the First Drop" marketing campaign. (Chair Dizmang)
- 4.4) Consideration and possible action on adding Section 4.10 – Directors' Social Media Communications Policy to PWD Rules & Regulations. (Chair Dizmang)
- 4.5) Discussion and possible action on list of annual community events for District participation. (Water Conservation Supervisor Roberts)
- 4.6) Discussion and possible action on Cash for Grass Program for 2013. (Water Conservation Supervisor Roberts)
- 4.7) Discussion and possible action on video media for front lobby. (Committee Member Alvarado)
- 4.8) Discussion and possible action on social media marketing campaign. (Committee Member Dizmang)
- 5) Old Business.
  - 5.1) Status of water cost comparison with different water districts and comparison to gas and electricity costs. (Chair Dizmang)
  - 5.2) Discussion of amendment to the District's Rules and Regulations regarding community presentations and policy for requesting District speakers and presentations. (General Manager LaMoreaux)
- 6) Information Items.
  - 6.1) Update on landscape workshops. (Water Conservation Supervisor Roberts)
  - 6.2) Update on 2012-2013 Water Awareness School Education Programs. (Water Conservation Supervisor Roberts)
  - 6.3) Status report on enhancing the District's web site and social media presence. (Information Technology Manager Stanton/Water Conservation Supervisor Roberts)
  - 6.4) Other.
- 7) Board members' requests for future agenda items.
- 8) Adjournment.



DENNIS D. LaMOREAUX,  
General Manager

**AGENDA ITEM NO. 4.5**

AV Events		PWD Events	Conservation Dept.	workshops		Saturday 9-12 am	Thursday 6-9 pm
* AV Home and Garden Show	March	AV Home and Garden Show	Mar. 22-24	PWD CFG Training	January	19th	31st
* Fix a leak week ( City of palmdale	Mar 18-24	Fix a leak week	Mar 18-24	AV College	January		
Almond Blossum Festival	March	Plant Fair (AVRCD grand opening)	May	PWD CFG Training	February	16th	28th
* Poppy Festival	April	Plant Sale (PWD)	June	AV College	February		
Plant Fair (AVRCD grand opening)	May	Student Summer Day Camp (PWD)	July	PWD CFG Training	March	16th	28th
* AV Fair Parade	August	Thursday Night on the square	Jul-Aug	AV College	March		
* Antelope Valley Fair & Alfalfa Festival	10 days			PWD CFG Training	April	20th	25th
* Thursday Night on the square	August-sept			AV College	April		
Armed Forces Apprication Day parade	September			PWD CFG Training	May	18th	30th
Septemberfest in Rosamond	September			AV College	May		
* International Heritage Festival	October			AV College	June		
Veterans parade	November			AV College	July		
* Palmdale Chamber Christmas Parade	December			AV College	August		
* Jet Hawks				AV College	September		
				AV College	October		

# PROCESS GUIDELINES

## PWD'S Cash for Grass Rebate Program

The Palmdale Water District (PWD) will use the following process for administering the "Cash for Grass Program." Please read everything carefully in order to STAY QUALIFIED.

Pages



### Do you Qualify / Submit Cash for Grass Application.

1

Do you Qualify  
Submit Application

1 DO YOU QUALIFY: View sheet one to see if you qualify for the "Cash for Grass Program"

1a APPLICATION: The owner of the property to be re-landscaped or the owner's legally-appointed representative must sign and submit the application. Keep other Cash for Grass work sheets handy. Some will be turned in later.

As soon as PWD receives your application a representative will call to set up an appointment to take pictures and measure the area. Wait for pre-conversion site visit from PWD before you take your grass out. PWD must measure and take pictures before your grass is removed (This is a Cash for Grass program requirement). After the initial first site visit a representative will call to let you know that you can proceed to the next phase of qualifying. You will be notified if you qualify for the \$.40 rebate amount, \$1.20, \$1.50 or the \$2.00 rebate amount The District will determine the rebate amount based on the condition of the existing grass and the completion of renovation requirements (NOTE: The District will only provide two inspections one for the initial picture taking and measuring and one for final completion inspection. A fee of \$30.00 for each additional trip will deducted from the rebate amount if the District is required to provide additional inspections.)

### Receive Training/ Design Landscape

If your application is approved, you will have 45 days to complete both of the following:

2

Receive Training  
Submit Design  
Submit plant list

2 You must either complete the free on-line landscape design class (about one hour) or attend PWD's in-classroom training. Training classes will be posted on our web site [www.palmdalewater.org](http://www.palmdalewater.org) or call PWD at 661-456-1020 or 456-1001 for the next available design class.

2 a PWD must receive a simple drawing showing the proposed design of your new landscape including the plant coverage sheet. This design must comply with the requirements spelled out on PWD's "Design Requirements." The drawings can be pencil drawings drawn by your average homeowner, and are not required to be done by professionals. PWD has developed several landscape designs that can be used. If you modify one of PWD's design plans you must provide PWD with your modified layout.

2b

### Install New Landscape Design

3

Install Landscape  
Submit Check List

3 You must complete the installation within six (6) months and complete the final check list and return it to PWD. The District will then contact you for final inspection. Please make sure everything on your check list is complete and that the landscape matches the design layout to continue to be qualified for the rebate. (NOTE: The District will only provide two inspections one for the initial picture taking and measuring and one for final completion inspection. A fee of \$30.00 for each additional trip will deducted from the rebate amount if the District is required to provide additional inspections.)

### Receive Incentive Rebate/ Maintain Landscape

4

Receive Rebate  
Maintain landscape

4 After completion of the project and final inspection the District will issue your rebate incentive in about 3-4 weeks. PWD expects that the owner's new landscape will be kept free of weeds and maintained for five full years after final inspection as stated in the Terms and Conditions of the contract.



# CASH FOR GRASS REBATE PROGRAM

1

## DOES MY GRASS QUALIFY FOR A REBATE?

PWD uses a sliding scale rebate based on the condition of existing grass and adhering to the conditions of the Rebate Application and Terms. To qualify for the “Cash for Grass” program you must have grass, rebates will not be given to customers with dirt, weeds and dead grass. Rebate amounts will be determined by staff and the decision will be final. **Do Not** take grass out until PWD has taken photos and measured the landscape area.



### Scale of Rebate Amount:

- (A) \$2.00 SF, healthiest grass
- (B) \$1.50 SF, green slight yellow spot
- (C) \$1.20 SF, green/ yellow spots
- (D) \$ 0.40 SF, yellow living grass
- (E) \$ none dead grass





Please Print:

## PWD's Cash for Grass Program Application and Terms and Conditions

1a

Page 1 of 2

Property Owner: \_\_\_\_\_ Contact person (if not owner): \_\_\_\_\_

Telephone #s: \_\_\_\_\_ Cell: \_\_\_\_\_ Account #s: \_\_\_\_\_  
Location and customer #s found on water bill

Address of site to be converted: \_\_\_\_\_ zip code: \_\_\_\_\_

Mailing Address: (if differs from mailing address) \_\_\_\_\_

### Instructions:

- 1) Read the *Terms and Conditions* on the second page of this form for program details.
- 2) Submit your original completed and signed application. Make a copy and keep for your records.
- 3) A representative from the District will call you and set up a pre-conversion site visit, to verify site qualifications, to take pictures, and measure the area, before you take grass out.
- 4) **Upon completion of the site visit PWD will inform you in writing that you have passed the first qualification phase and provide you with the determined rebate amount.**
- 5) **After you have passed the first qualification phase, within 45 days, you must take landscape design training online or go to a PWD Cash for Grass workshop. Draw and submit your simple landscape design plan, fill out the plant coverage sheet and submit to PWD.**
- 6) Upon completion of your newly designed landscape (within 6 months) complete the final check list and submit to PWD. The District will then contact you for final inspection. Please make sure everything on your check list is complete and that the landscape matches the design layout to continue to be qualified for the rebate.

*(Note: The District will only provide two inspections one for the initial measuring and one for final completion inspection. A fee of \$30.00 for each additional trip will be deducted from the rebate amount if the District is required to provide additional inspections.)*

**Important: You must participate in a pre-conversion site visit before removing your lawn.  
Starting without approval will make your rebate application ineligible.**

I have read and understand Palmdale Water District's program requirements as stated in this application. I further understand that I must be the property owner or the owner's legally-appointed representative in order to claim any funds. I agree to participate in a free, post site evaluation if contacted by Palmdale Water District. Furthermore, I agree to allow Palmdale Water District to track the property's water use and conduct post site inspections for the duration of the five year period. Any claims about defects or performance of the selected landscape materials will be between me and the manufacturer / distributor of the product. Palmdale Water District specifically disclaims any representations or warranties about any landscaping products, whether expressed or implied.

Please sign at the bottom, initial the second page, include attachments and mail to:

Palmdale Water District --- Cash for Grass Program

Attention: Claudette Roberts, Water Conservation Manager

2029 East Ave. Q

Palmdale, California 93550

Signature Required:

I certify that I am the property owner or the owner's legally-appointed representative. I understand and agree to the program conditions on the second page of this form.

\_\_\_\_\_  
Applicant's Signature

\_\_\_\_\_  
Print Name

Date: \_\_\_\_\_

Did you include? ☐ Copy of Water Bill ☐ Authorized Signature ☐ Initials on page two (2)



### ***Eligibility:***

- 1) Funds are available to single family residential, multi family, or commercial customers of the Palmdale Water District.
- 2) Front yards only with a minimum of 400 sq. ft. or more of grass must be converted (Side and back yards are not eligible.)
- 3) All plants must be on the City of Palmdale's approved list or from the booklet "Plants for the California High Desert".
- 4) You must submit a simple landscape design plan using PWD's design criteria, fill out the plant coverage sheet and return to the District within 45 days.
- 5) Replacement surfaces must be **permeable to water and air. SOLID PLASTIC MATERIAL WILL NOT BE ACCEPTED**
- 6) Existing irrigation systems must be modified to eliminate spray irrigation.
- 7) The rebate amount is based on a sliding scale from \$.40 per square foot (SF), \$1.20 SF, \$1.50 SF, or \$2.00 per SF dependent upon the condition of the existing grass and qualifying throughout the project.
- 8) Participants must be willing to keep new landscape in place and maintained for a minimum of 5 years.
- 9) ***Important: You must participate in a pre-conversion site visit before removing your grass. The District must take pictures and measure the area. Starting without approval will make your rebate application void.***

### ***Requirements for the Converted Landscapes***

#### ***Design Plan:***

Within (45) days after PWD has measured and taken pictures of your landscape you must submit a simple landscape design plan including the plant coverage sheet and return to PWD to continue to be qualified. You may design your own layout or you may use one of the design layouts created by PWD. Please follow PWD's design criteria either way to continue to be qualified. Read design criteria sheet, go online and take design training or come to a design workshop provided by PWD to continue to be qualified. Call PWD at 661-456-1020 or 456-1001 for more information.

#### ***Plantings:***

At completion, the new landscape must match the design plan you submitted to PWD. Converted planted areas must be water wise plants from City of Palmdale's plant list. At least 400 sq. ft. of lawn must be converted. At maturity at least 60% of the landscape area must have plant coverage. Existing plants or trees may be considered as part of the 60% coverage. Your redesigned landscape must be based on PWD's design criteria. You must fill out the plant coverage sheet and to submit to PWD including your landscape design plan within 45 days.

#### ***Surface Treatments:***

Converted areas must be permeable to air and water. Surface treatments such as mulches of rock, gravel, bark, and small amounts of ungrouted stepping stones are recommended. If a weed barrier is used it must be manufactured to be permeable to air and water.

***Concrete, plastic sheeting, or other impermeable treatments do not qualify.***

#### ***Irrigation:***

Existing irrigation systems and schedules should be modified to efficiently irrigate the new water-wise landscape. Irrigation systems must be modified to eliminate spray irrigation. Efficient irrigation systems, such as drip, bubblers, smart controllers are encouraged.

### ***Terms of the Program***

This agreement expires in six months. The six-month term begins the day after a site inspector from Palmdale Water District measures and takes pictures of the site and ends at 5:00 p.m. on the first business day after six months have elapsed. A minimum of 400 sq. ft. of qualifying area per property, per owner, will be funded at \$0.40 SF, \$1.20 SF, \$1.50 SF or \$2.00 SF depending on initial qualification. Checks are issued to the property owner.

#### ***Final Inspection***

Once you are completed with the landscape conversion you must submit the "Inspection Check List" to PWD. After PWD receives the check list a representative from PWD will call to make an appointment to inspect the site and verify compliance. If the conversion fails inspection, you will have 60 days or the remainder of the six month period, whichever is greater to fully comply with the program conditions. ***(Note: The District will only provide two inspections one for the initial measuring and one for final completion inspection. A fee of \$30.00 for each additional trip will be deducted from the rebate amount if the District is required to provide additional inspections.)***

#### ***Requirements to sustain conversion***

The converted area must remain in compliance with all program conditions for a period of 5 years. If this requirement is violated you may be required to refund all or a portion of the program payment. The agreement is void upon transfer of property.

#### ***Other responsibilities of the applicant***

Palmdale Water District enforces only the conditions of the Cash for Grass program agreement. The applicant is responsible for complying with all laws, policies, codes and covenants that may apply. Quality and appearance of the conversion is the responsibility of the applicant. By participating in the program you agree to allow Palmdale Water District to track your water use and conduct post site inspections for the duration of the five year period.



# TRAINING

2

Page 1 of 2

There are two options for training on creating a “Landscape Design” listed below: Landscape Design Training includes: Introduction to design, basic principals of design, creating the design, drainage, safety, plant design, layout, installing the landscape, and working with Professionals. Also included is a section on irrigation.

1. Online- [www.palmdalewater.org](http://www.palmdalewater.org) PWD offers a training course on landscape design. Find the course under conservation/ “Cash for Grass” Training. Read the material, answer the questions and submit.
2. A schedule of PWD’s “Cash for Grass” workshops can be found on the District’s web site [www.palmdalewater.org](http://www.palmdalewater.org) under conservation. Sign up and attend a Palmdale Water District “Cash for Grass” workshop. There will be several Landscape Design workshops available on Saturday mornings 9-12 am and Thursday nights 6-9 pm.



Before



After





## Planning it out first....

Most challenges and failures in High Desert Waterwise Landscaping arise due to poor planning. Do not purchase landscaping materials without first planning out your landscape design. By planning your landscape out on paper you can reveal where weaknesses occur such as drainage issues and what areas you would like to improve such as pathways to the front entrance or wind blocks. As you go through the training on basic landscape design you will find there is much to learn, but the payoff in saving time and money is well worth the effort.

### Planning a Landscape:

- Conduct a site evaluation – identify positive and negative features, and environmental conditions of the planting site or landscape.
- Identify landscaping goals – consider how you plan to use the area.
- Create a bubble diagram – define areas for each planned use of the landscape.

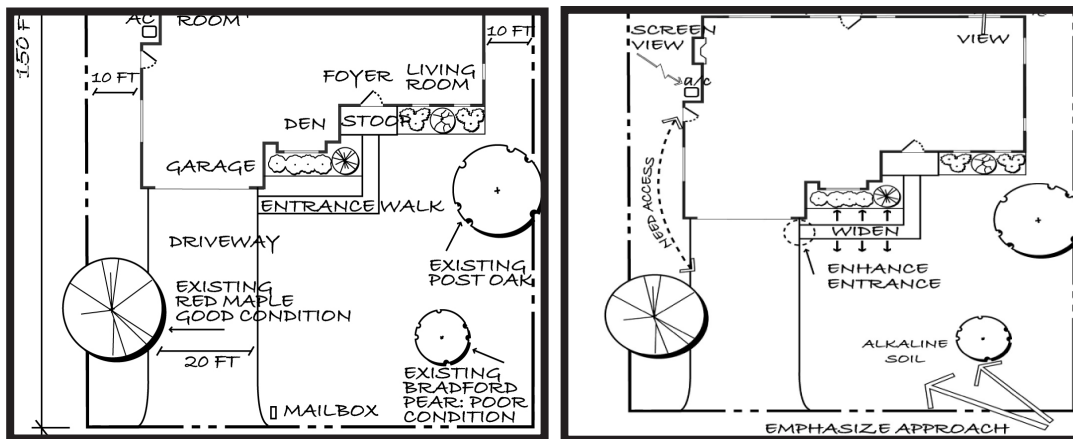

**Consider the maintenance aspect.** Do you love working in the yard and garden, getting your hands dirty, pruning and weeding? Maintenance is a big part of a great landscape, but a great landscape doesn't have to be high maintenance if you plant it well. If you like planting annuals every year, you need to consider what spaces you will leave for annuals. If you simply want to get it done and let it grow, you should fill your space with perennials or self-seeding annuals so that you don't have to plant every spring.

**Consider the plant options.** Using native plants is becoming more and more popular, and will contribute to a more low-maintenance landscape. Do you prefer to have a lot of blooms or more greenery? Do you like color all season? What about winter options? Do you want some evergreens near the house or driveway for some green all year round? Do you want to grow flowers you can cut and bring inside for arrangements? Take a look at websites, garden catalogs and landscaping books to get an idea of the type of plants that are appealing to you.

**Consider decorative options.** Would you like to have a big visual impact with a fence, gate, gazebo, large stones or water feature? Is outdoor lighting important for grilling parties and kids playing? Before you start drawing in your plants, draw in your decorative features, as you will have less flexibility with where they go. Accessories may be both functional and decorative (as a fence and a gate). Place it where it makes the most sense for the way you and your family already use the yard. For example, if you want to put in a stone path, and your kids already cut across the yard in a certain pattern, go ahead and put the stone path where they already walk. Go with the flow and let the landscape elements work for your family rather than trying to retrain your spouse and children.

## LANDSCAPE DRAWING /LAYOUT

The Palmdale Water District expects most of the drawings (landscape Layouts) will be pencil drawings drawn by your average homeowner not professionals. PWD has developed several landscape design plans that can be used. If you modify one of the PWD's design plans you must provide PWD with your modified layout. Please use the instructions below for drawing your layout...

### INSTRUCTIONS FOR DRAWING YOUR LAYOUT

- 1) Top of page on the right hand side write your name and address.
- 2) Use an 8.5 x 10 or 8.5 x 14 piece of plain white paper or velum.
- 3) Using the example below sketch the garage, house, and front landscape. You can ask for a copy of the layout PWD drafted, when the existing landscape was measured and you may draw over the PWD layout.
- 4) Draw hardscape such as: driveway,s walkways, or plantors.
- 5) Draw edging to keep divided areas apart such as: metal, concrete, or wooden edging .
- 6) Draw plants and trees using some type of shape (symbol) as shawn below.
- 7) Name material in each section of your layout such as: decomposed grante, decorative rock, mulch, pebbles, large boulders or other decorative items.
- 8) Draw exiting plants, shurbs, or flowers.
- 9) Draw a legend that identifies plants on the layout and the amount of plants that will be used in the landscape.
- 10) A successful landscape design will have several elements; such as a water feature, large boulders, lighting, landscape art, walkways, edging, differnet textures or color patterns.
- 11) Read the Design Tips on page three to plan your landscape design. Sign up for a "Cash for Grass" workshop held at the District office or take the on-line landscape design class at [www.palmdalewater.org](http://www.palmdalewater.org) under conservation/ Cash for Grass Training Read the material, answer the questions, and submit.

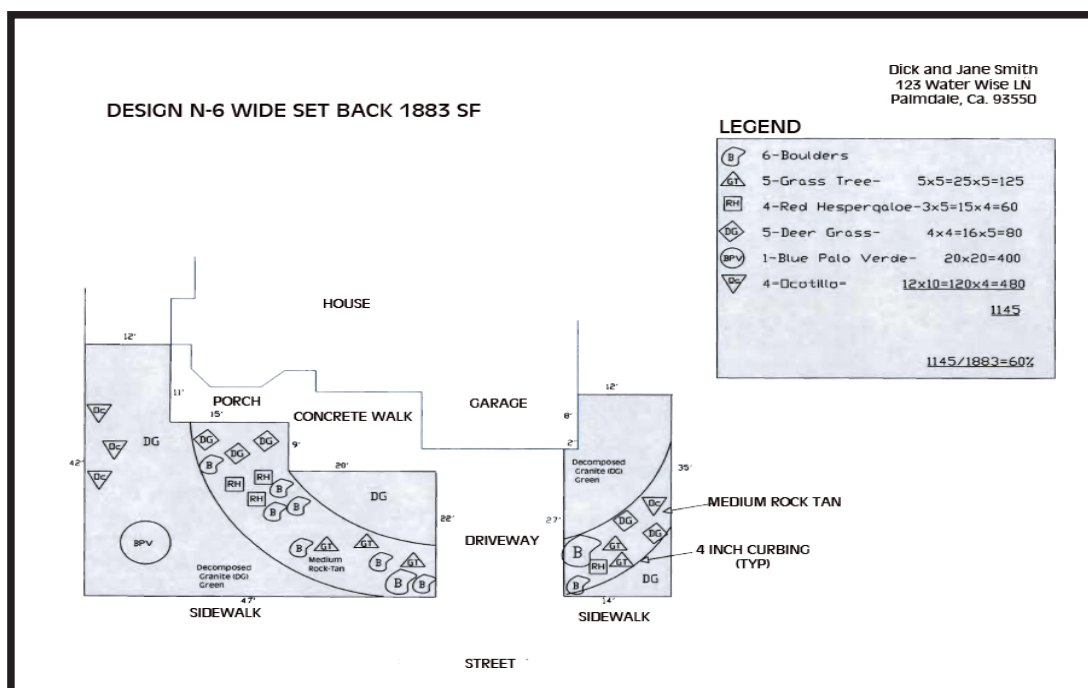





Shown to the left are a couple of before and after photos. The customer left a small patch of grass in the front for an interesting look. The layout was well planned and complemented the house.

The Landscape to the right shows another dry creek bed. The slope in the landscape created drainage problems that have been corrected by the new landscape design.



To make your Landscape POP use color, this image shows complimentary colors with an array of textures. Color can be used in a planter near the front entrance or in containers.





## Helpful Tips for Planning your Landscape Design

### Group by Hydrozones

Plants are often categorized by how much water they require, or their hydrozone. When designing your garden it is wise to group together plants that have similar watering needs. This is particularly important with High Desert California plants since over watering will actually harm many drought-tolerant plants.

### Capture Runoff

Although we may not get much rain in the High Desert every drop counts! Slowing down the flow of runoff through your landscape will allow more of it to infiltrate into the groundwater and also slow erosion. This can be accomplished through the use of groundcovers, but also with a series of rocks and boulders to create a “dry streambed.” If your property is sloped, towards the street, you may want to install an infiltration basin, an underground layer of sand, gravel or other coarse material.

### Shade

When planning your garden, it is important to consider how much sun different areas of your garden will receive. Most California-friendly plants prefer sun, but there are some plants that thrive in shade. Many varieties of Lilies and Coral Bells will do well in shade and also have beautiful flowers!

### Blooms

There are a number of plants that bloom during the fall & winter. You may want to select plants that bloom during the winter to brighten up your garden during gray days, or autumn bloomers to give your garden a “fall feel.” Your garden doesn’t have to be stark or bare during the other 3 seasons!

### Maximum Size

When placing plants, it is important to consider their maximum size. We all want our gardens to be healthy, and that means that the plants will grow! Be sure to allow adequate space between plants and away from buildings to avoid problems later on. If you feel that your garden looks too sparse, you can always sprinkle wildflower seeds in for a seasonal burst of color!

### Color

Color coordination is a must for any landscape. You can choose to coordinate between plants, or with your house. Complementary colors will blend, while contrasting colors will make your landscape “pop.” You may want to use a color wheel while designing, or select several shades to serve as your color pallet.

### Irrigation

There are many irrigation options available. It is important to consider the slope and flow paths of your property as well as the placement and root systems of your plants. Drip irrigation, Bubblers, Rotating Sprinkler heads and hand watering are all efficient ways to irrigate your garden.

### Hardscape

The days of boring concrete patios are over! There are many different hardscape options that will be as attractive as your plants. By spacing pavers or bricks, you are able to create patterns while allowing water to infiltrate back into the soil. Decomposed Granite (DG) is a popular material for paths and meandering walkways. Hardscape is often the most expensive portion of a garden, so budget wisely!

Send us your design

After you have completed the design of your new landscape and filled out the plant coverage sheet in accordance with the Design Requirements, send it to us, along with any additional information as necessary, using one of these three options

1. Email the documents to [croberts@palmdalewater.org](mailto:croberts@palmdalewater.org)
2. Fax the documents to "Cash For Grass" at (661) 947-8604
3. Send U.S. Mail or personal delivery to:

Cash for Grass Program  
Palmdale Water District  
Attention Conservation Dept.  
2029 East Avenue Q  
Palmdale, Ca 93550



Featuring PWD's Cash for Grass customer designs and installations

## SAMPLES OF LANDSCAPE SYMBOLS

### Large evergreen trees



### Ornamental trees



### Groundcovers

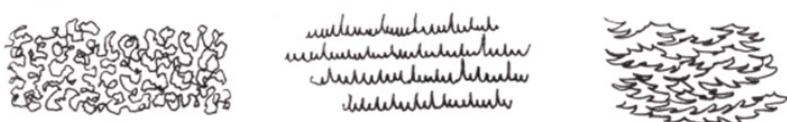

### Accent or specimen plants (more detailed than other graphics)



Landscape symbols can be used to identify plants. Let different symbols represent a plant, tree or item on the plan, then make a legend and list the plant's common or botanical name or item name, such as large boulder or Mexican Evening Primrose.



## PWD's Cash for Grass Program

### *Instructions for Completing the Plant Coverage Worksheet*

Fill out the Plant Coverage Worksheet on the reverse side and return to PWD with your landscape design plan within 45 days of application approval.

As part of the criteria for the Cash for Grass Program the customer must list existing plants and trees that will be kept in the landscape and new plants or trees that are brought into the landscape. All new plants and trees must be water wise type and are on the approved plant list or in the booklet ( Plants for the California High Desert).

- 1) List the names of the plants for your conversion in column (A) (EXISTING AND NEW PLANTS).
- 2) Use the conversion plant list to find the plant coverage value (square footage) for each plant in your new landscape enter that in column (B).
- 3) List the quantity of each plant to be included in your landscape conversion in the quantity column (C).
- 4) Multiply column (B) by column (C) to get total plant coverage for each plant and enter in column (D)
- 5) Add the plant coverageS in column (D) and place in (E) below.
- 6) Enter the square footage of grass you plan to remove in (F) below.
- 7) Divide the Grand Total Plant Coverage (E) by the square footage you plan to convert (F) and multiply that value by 100 to get the total plant coverage (G) for your landscape plan.

#### **Sample:**

	(A) Plant Name	(B) Plant Coverage Value			(C) Quantity	(D) Total Plant Coverage	
1	Trailing Lantana	28	ft <sup>2</sup>	x	3	(=)	84ft <sup>2</sup>
2	Chilean Mesquite	530	ft <sup>2</sup>	x	2	(=)	1060ft <sup>2</sup>
3	Green Desert Spoon	28	ft <sup>2</sup>	x	3	(=)	84ft <sup>2</sup>
4	Red Bird of Paradise	28	ft <sup>2</sup>	x	1	(=)	28ft <sup>2</sup>
5	Red Yucca	7	ft <sup>2</sup>	x	3	(=)	21ft <sup>2</sup>
6	Compact Texas Ranger	20	ft <sup>2</sup>	x	4	(=)	80ft <sup>2</sup>
7	Ocotillo	28	ft <sup>2</sup>	x	1	(=)	28ft <sup>2</sup>
(E) Total Plant Coverage Values (Square feet) (=)							<u>1385 ft<sup>2</sup></u>
(F) Turf Conversion Area (grass to be removed) (=)							<u>1012 ft<sup>2</sup></u>
G) Plant Coverage [ (E/F) x (100)] (=)							136%
(1385/1012 = 1.36 x 100 =136 %)							

Divide the total plant coverage value (E) by the Turf Conversion area (F) and multiply by 100 equals percent of plants back into the landscape 136% which is over the 60% that is required.



# Plant Coverage Worksheet

PWD's Cash for Grass program

NAME: \_\_\_\_\_

ADDRESS: \_\_\_\_\_



Submit to PWD with your Landscape Design plan within 45 days of application approval

(A) Plant Name	(B) Plant Coverage Value (Square footage of plant)	(C) Quantity	(D) Total Plant Coverage Values ( Total Square Footage of Plants)
1 _____	_____ ft <sup>2</sup>	X _____ =	_____ ft <sup>2</sup>
2 _____	_____ ft <sup>2</sup>	X _____ =	_____ ft <sup>2</sup>
3 _____	_____ ft <sup>2</sup>	X _____ =	_____ ft <sup>2</sup>
4 _____	_____ ft <sup>2</sup>	X _____ =	_____ ft <sup>2</sup>
5 _____	_____ ft <sup>2</sup>	X _____ =	_____ ft <sup>2</sup>
6 _____	_____ ft <sup>2</sup>	X _____ =	_____ ft <sup>2</sup>
7 _____	_____ ft <sup>2</sup>	X _____ =	_____ ft <sup>2</sup>
8 _____	_____ ft <sup>2</sup>	X _____ =	_____ ft <sup>2</sup>
9 _____	_____ ft <sup>2</sup>	X _____ =	_____ ft <sup>2</sup>
10 _____	_____ ft <sup>2</sup>	X _____ =	_____ ft <sup>2</sup>
11 _____	_____ ft <sup>2</sup>	X _____ =	_____ ft <sup>2</sup>
12 _____	_____ ft <sup>2</sup>	X _____ =	_____ ft <sup>2</sup>
13 _____	_____ ft <sup>2</sup>	X _____ =	_____ ft <sup>2</sup>
14 _____	_____ ft <sup>2</sup>	X _____ =	_____ ft <sup>2</sup>
15 _____	_____ ft <sup>2</sup>	X _____ =	_____ ft <sup>2</sup>
16 _____	_____ ft <sup>2</sup>	X _____ =	_____ ft <sup>2</sup>
17 _____	_____ ft <sup>2</sup>	X _____ =	_____ ft <sup>2</sup>
18 _____	_____ ft <sup>2</sup>	X _____ =	_____ ft <sup>2</sup>
19 _____	_____ ft <sup>2</sup>	X _____ =	_____ ft <sup>2</sup>
20 _____	_____ ft <sup>2</sup>	X _____ =	_____ ft <sup>2</sup>

Total all plant square footages (E), divide that number by the square foot area you are renovating (F), multiply that number by 100 to get the total plant coverage area. The plant coverage area should be 60 percent or more.

(E) Total Plant Coverage values = \_\_\_\_\_ ft<sup>2</sup>

(F) Customer Turf Conversion Area = \_\_\_\_\_ ft<sup>2</sup>

(G) Plant Coverage [ (E/F) x (100) ] = \_\_\_\_\_ %

## INSPECTION CHECK LIST

In order for the District to proceed with final inspection you must complete the check list and send it back to the Palmdale Water District, Attention Conservation Department, 2029 East Avenue Q, Palmdale, Ca 93550 or FAX Attention Conservation Department 661 947-8604 or e-mail [croberts@palmdale-water.org](mailto:croberts@palmdale-water.org). A representative from the District will call to make an appointment for final inspection after receiving completed check list.

NAME: _____ ACCOUNT #s _____ - _____
SITE ADDRESS: _____ PHONE # _____

I have...

- ☐ 1. Read and understood the Application, Terms and Conditions, and the Design requirements.
- ☐ 2. Received initial approval of application and rebate amount.
- ☐ 3. Attended a PWD landscape design class or completed the online landscape design class
- ☐ 4. Submitted my landscape design plan and filled out my plant coverage sheet within 45 days.
- ☐ 5. Received final approval of my landscape design plan
- ☐ 6. Read information on "How to kill your Grass" and proceeded to make sure grass was completely dead
- ☐ 7. Removed and disposed of dead grass or other unneeded materials
- ☐ 8. Upgraded the irrigation system as needed....either capped off irrigation sprinkler-heads and or installed bubblers or drip irrigation.
- ☐ 9. Installed hard-scape (if needed)
- ☐ 10. Used acceptable permeable to air and water weed barrier (NOT PLASTIC)
- ☐ 11. Installed new plants that were listed on the design plan and the plant coverage sheet that was submitted and approved by PWD
- ☐ 12. Completely covered all areas of the yard with mulch, rock, decomposed granite or other form of landscape material. (NO BARE SPOTS)
- ☐ 13. Determined that the design plan and new landscape match each other. My design plan DOES NOT differ from my new landscape

I verify that the statements I have checked off are true and that the District may now contact me regarding final inspection in order for me to receive my rebate amount.

Sign: \_\_\_\_\_ Date: \_\_\_\_\_

## Receive Incentive Rebate

After completion of the project and final inspection the District will issue your rebate incentive in about 3-4 weeks. *(Note) The District will only provide two inspections one for the initial measuring and one for final completion inspection. A fee of \$30.00 will be deducted from the rebate amount if the District is required to provide additional inspections.*

## Maintenance of High Desert Landscaping

PWD expects that the owner's new landscape will be kept free of weeds and maintained for five full years after final inspection as stated in the Terms and Conditions of the contract. Desert landscaping helps save you time when it comes to maintaining your property, but it doesn't mean that it is upkeep free.

### Weeds

A small weed can stand out even from a distance amidst the rocks. Remove weeds while they're still small so that they will not overpower your High Desert landscape. Using herbicides and a hoe will work on larger weeds. When using decorative rocks use a garden hose to remove debris and loose dirt. Replace some rocks that washed away after a heavy downpour, well if we ever have a downpour. You may have to regularly apply a "pre-emergent" herbicide to keep weeds from sprouting, or try applying cornmeal as an organic weed preventer to the seedlings. Always use natural solutions when possible. Boiling water and salt water are long-lasting, easy, inexpensive solutions to a common weed problem.



### Watering

A properly designed desert landscape should already minimize your watering needs. A good watering schedule will ensure that your desert landscaping will grow and maintain to its full potential. Be sure to water early in the day to avoid needless evaporation. Also plan on watering in short bursts more frequently rather than one long session. This gives the water a chance to be absorbed into the desert landscaping and prevents runoff. Verify that the amount of time you are watering is appropriate for the season. A watering schedule should be altered every one or two months to best meet the needs of your plants without wasting water. Make sure that you have plants that have similar watering needs together, so you are not over watering some plants and under watering others plants with in your desert landscaping.

### Pruning

When you design a desert landscape, you should try to accommodate the full-grown plants. This will help eliminate the need for extensive pruning. For the first few years of your landscape, you may not need to do any pruning at all. Because of the type of plants that are common to desert landscaping, take a modest approach when pruning. You want to remove any dead or broken branches, or any that show signs of disease. Trees can be carefully pruned to retain their shape. Be careful to prune during the appropriate times of the year. A safe time to prune your desert landscaping is late winter or early spring.



# RESOURCES

## PWD'S CASH FOR GRASS PROGRAM



All of these designers are local and experienced with drought tolerant landscaping

### LANDSCAPE DESIGNERS:



Glenn's Lawn Care  
Glenn Guenther  
(661) 728-1444

AV Garden & Turf  
Rob Schrader  
PO Box 423  
Littlerock, Ca.  
(661) 944-3831

Greenbee Nursery  
Brad Hayes  
2505 East Avenue Q  
Palmdale, Ca.  
(661) 274-2331

### LOCAL NURSERIES:

Greenbee Nursery  
Brad Hayes  
2505 East Avenue Q  
Palmdale, Ca.  
(661) 274-2331

Superior Nursery  
42607 Sierra Hwy  
Lancaster, Ca  
(661) 723-0180

### STONE, PAVERS, HARDSCAPE MATERIALS:



California Quarry Products  
4257 3rd St East  
Lancaster, Ca  
(661) 942-3992

Jaqua & Sons  
1050 West Columbia Way  
Lancaster, Ca  
(661) 942-1183

American Builder Supply Inc.  
37949 6th St East  
Palmdale Ca.  
(661) 947-2117

Crown Landscape & Building Supply  
35654 Sierra Highway  
Palmdale , Ca  
(661) 274-4000

DCF Soils  
352 Sierra Hwy  
Palmdale, Ca  
(661) 266-2574



### IRRIGATION:



Smith Pipe & Supply  
42913 N. Sierra Hwy  
Lancaster, Ca 93534

AV Turf Supply  
45350 Trevor Avenue  
Lancaster, Ca. 93534  
(661) 949-2561

Desert Industrial  
38613 6th St East  
Palmdale, Ca.  
(661)-276-7673

Hunter Industries  
1940 Diamond St  
San Marcos, Ca.  
[www.hunterindustries.com](http://www.hunterindustries.com)

Rainbird  
970 West Sierra Madre Ave  
Azusa, Ca.  
(626) 812-3400  
[www.rainbird.com](http://www.rainbird.com)

Rainbird  
PO Box 37  
Glendora, Ca.  
(626) 963-9311  
[www.rainbird.com](http://www.rainbird.com)

EWING  
7530 N Ingram Ave.  
Fresno, Ca.  
(559) 438-9530  
[chawkins@ewing1.com](mailto:chawkins@ewing1.com)

1. The Palmdale Water District does not endorse specific brands, products, or dealers; nor does it guarantee materials or workmanship; acceptance of such is the sole responsibility of the customer.
2. PWD assumes no responsibility or liability for any damage that may occur to an applicant's property as a result of participation in any District program.



## KILLING EXISTING TURF AND WEEDS

### PWD's Cash for grass program

The best way to kill the existing lawn and weeds is to apply a nonselective herbicide, such as glyphosate, over the entire area. Glyphosate is a postemergence translocated herbicide that effectively kills turf and grassy and broadleaf weeds. Glyphosate is translocated rapidly in all actively growing plants. Make applications when your turf is actively growing. Do not water within 48 hours after treatment. Though the plants absorb the herbicide rapidly, do not disturb for 7 days. It may take up to 7 days after the application for the grass to completely absorb the material and for symptoms to show. Depending on temperature, it can take up to two weeks for the entire lawn to die.

If you do not wish to use herbicides, you can dig out the existing lawn and solarize the soil (SEE BELOW) Alternatively you can lightly moisten the soil and rototill it. You may need to till the soil several times to remove all of the turf and weeds, raking up the debris in between tillings.

Be sure to follow the directions on the label and be careful not to spray on a windy day or if rain is expected within 48 hours.



#### **Remove the remaining turf...**

If you applied herbicides, mow the dry grass at a very low setting, so that the blade is cutting just above the soil line. Rake up the clippings. A thatching rake can help to loosen the debris on the soil surface. If you dug out the lawn or rototilled the soil, remove the debris by raking the soil. Additional tilling and raking may be necessary until all the grass and weeds are removed.

### Soil solarization:

Soil solarization requires that the soil first be prepared for planting. First, cultivate the soil and smooth the surface, but do not pack it down. Next, wet it very well. After irrigating, immediately roll clear polyethylene plastic tarps one mil (0.001 inch [0.025 mm]) thick over the surface, smoothing out air pockets. Thicker tarps, 1.5 to 2 mils can be used in windy areas (avoid thicker 4 - 6 mils as they are more reflective and don't allow the soil to heat up as much). Bury the edges of the tarp with soil. Tarps should be left on the soil surface for 4 - 6 weeks during the hottest part of the year. Do not leave the tarp on for more than 6 - 7 weeks, as it will become brittle and difficult to remove.

